



Description of the main icons

ICONS	DESCRIPTION
	Transmitting a one-way call
	Receiving a one-way call
	Status message/s received
	Battery bar icon
	Signal strength bar icon
	Loudspeaker in use
	Loudspeaker and earpiece not in use
	Top microphone selected
	Speakers and tones muted
	Keypad locked
	Text message/s received
	Scanning activated
	Air interface encryption not in use
	Transmission barring active
	GPS receiver on

TRA/TR/APP/00035 01.01/EN

THR880i Quick Guide

UM
PS11358AENAA01
05/2012



AN EADS COMPANY

DEFENDING WORLD SECURITY



Getting familiar with your radio



Getting started

Install the battery

- 1 Press the release button upwards to open the battery cover



- 2 Slide the battery in the radio body
- 3 Slide the battery cover downwards with your thumbs so that the locking catches near the hinge are pushed under the cover (1) and press it down until it clicks (2)

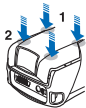

Switch the radio on

- 1 Press and hold the power on/off switch
- 2 If the radio asks for a phone or a security code, enter these and select **OK**

Note: the initial phone code is 1234

Note: this Quick Guide aims at helping users get started with their radio. The detailed information on radio usage is available in the full User Guide at <https://pmronline.cassidian.com>.

Making and receiving calls (1/2)

Make a call



Group call

- 1 Press 
- 2 Scroll to the desired folder
- 3 Choose **Select**
- 4 Turn the group selector until you reach the desired group
- 5 Press and hold the PTT key
- 6 Start speaking when a short tone is played

Express call

- 1 To a TETRA number: type the number
To a phone number: type the number, press  and scroll to *Phone*
- 2 Press and hold the PTT key

Phone call

- 1 Enter the area code and phone number
- 2 Press 
- 3 Scroll to the relevant number type among *Private*, *Abbr. number*, *Phone*, or *Office ext.*
- 4 Press 

Making and receiving calls (2/2)

Red key call

Press and hold the red key-call button to call the predefined destination

Call in direct mode

- 1 Select **Menu** → *Settings* → *Phone settings* → *Active mode* → *Direct*
- 2 Turn the group selector until you reach the desired channel and press the back key to select the relevant group
or
enter the recipient's number
- 3 Press and hold the PTT key

Respond to a call

Phone call

Press 

Group or Express call

- 1 Press and hold the PTT key
- 2 Start speaking when a short tone is played



Sending text messages

Send a status message

- 1 Press 
- 2 Scroll to the relevant status message
- 3 Select **OK**
- 4 Enter the phone number or search for the recipient
- 5 Select **OK**
- 6 Scroll to the relevant number type
- 7 Select **Send**

Send a text message

- 1 Press 
- 2 Write the message
- 3 Select **Send**
- 4 Enter the phone number or search for the recipient
- 5 Select **OK**
- 6 Scroll to the relevant number type
- 7 Select **Send**

Note: your organisation may predefine different functions for the  and  key